

admetec



butterfly iQ+

Instructions for Use

Introduction

Thank you for choosing **admetec**

Meet the **Butterfly^{evo}**, Admetec's cordless headlight series, featuring two models designed for optimal efficiency.

Using a battery pack gives the user complete portability allowing unrestricted movement.

Butterfly^{evo} benefits:

- **Cordless:** Freedom of movement increases comfort and efficiency
- **Lightweight:** Optimized weight distribution, ergonomically designed to rest lightly on your loupes
- **User-friendly controls:** Simple operation with tap controls for ON/OFF and light intensity
- **Swift battery replacement:** Enabled by magnetic mount.
- **Compatible:** Can be mounted on most loupes models

Product overview

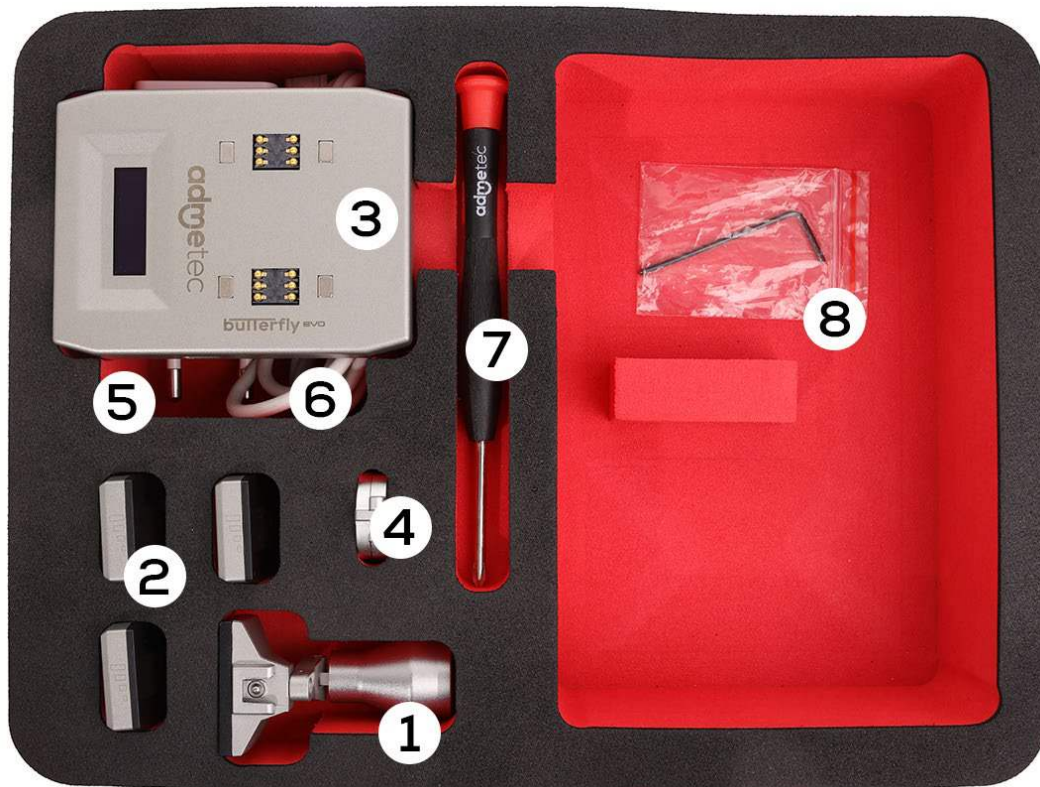

Fig. 01 – Butterfly^{evo} Case

This image is for illustration only. There are some differences in the batteries between Butterfly^{evo} models

Your Butterfly^{evo} comes with:

1. Light Source
2. Butterfly Batteries
3. Charging Pad
4. Yellow Filter (composite)
5. AC/DC USB
6. USB Type-C Cable
7. Screwdriver
8. Allen Key

Safety Precautions

Do not use any third-party chargers with **Butterfly^{ev0}** Charging Pad even if they look identical. Third-party chargers are not compatible with the battery packs and could damage it.

Prevent battery packs from overheating. Avoid direct sunlight or heated surfaces.

Prevent battery packs from shock.

Do not use close to explosive or highly flammable materials like alcohol, methanol, acetone, etc.

Notice that any serious incident should be reported to the manufacturer and Competent Authority in which the patient is established.

Troubleshooting

Issue	Troubleshooting
The light does not work steadily due to discharged battery	Replace battery pack. Charge the discharged battery
Battery does not function	Contact local dealer.
LED failure	Contact local dealer
Battery overheats or produces fire while charging	Contact local dealer
Battery leakage	Contact local dealer
Battery swelling	Contact local dealer
Touch is not responding	Contact local dealer

Charging Pad

To charge the battery,

1. Connect charging pad to AC/DC USB charger using the provided USB cable.
2. Plug the AC/DC USB charger into a wall outlet.
3. Place the battery pack on the charging pad as shown in Fig. 02. It is possible to charge two battery packs simultaneously.

The charging percentage indicators on the display screen serve as visual real-time charging status of individual batteries.



Fig. 02 – Batteries connected to charging pad.

Average charging time for an empty battery is 1.5 hours.

Battery packs may remain on the charging pad when not in use.

Battery pack

Each **Butterfly^{evo}** kit includes 3 battery pack units serving as power source and a charging pad to charge the batteries.

Battery packs control – turning the light source ON and OFF. This function is controlled by touching the area marked in green in Fig. 03

Dimming the light source in two different intensities is controlled by touching the area on the right side of the battery, marked in green on Fig. 04.



Fig. 03 – Battery pack (aerial view)



Fig. 04 – Battery pack (Dimmer / right side)



Battery pack magnet connector (bottom view)

Notes



The battery pack supports a constant level of light intensity during the whole period of discharging. Once the battery is fully discharged, the light turns off.

Light source

- hinge allowing for tilt adjustment of the light direction. [Fig. 09]
- battery magnets connection pad [Fig. 08]
- Admetec adaptor for mounting the headlight on frames. [Fig. 06]

Getting started:

1. Mount the external yellow filter onto the front part of light source by lessening the external filter ring with the Allen key and pushing the outer ring of the filter onto the front part of the light source as shown in Fig. 05.

*Note: Use the Allen key attached to tighten/lessen the ring.

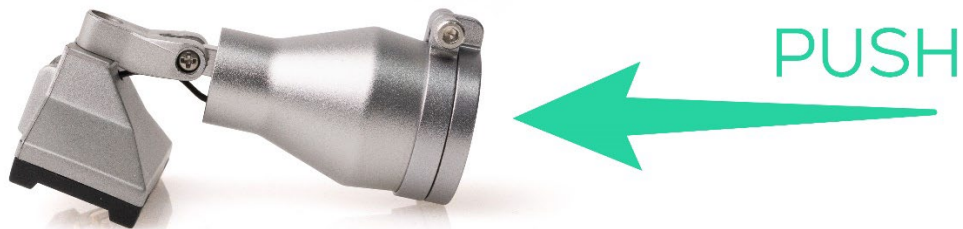

Fig. 05 – Mounting external yellow filter (composite)

2. Attach the light source to the Admetec frame adaptor or on the universal adapter as shown in Fig. 06 and Fig. 07

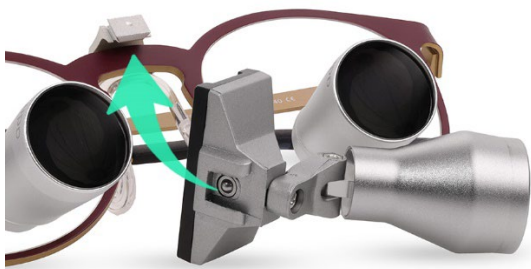

Fig. 06 – Attaching the headlight on the loupes frame



Fig. 07 – Attaching the headlight on the Universal Adaptor

3. Place the battery pack on the magnet connection pad. The battery pack must be oriented so that the Butterfly logo faces ahead. The magnets will align the battery electrodes with the connection pad.

Notes



When attempting to place battery pack in reversed position, the magnets will not allow it to be attached to the connection pad.

4. Once the battery pack is aligned, turn your light on.



Fig. 08 – Butterfly^{evo} mounted on frame.

5. Adjust angle of the light direction to get light beam visible through the loupes.



Fig. 09 – Adjusting the Butterfly^{evo} headlight angle.

Technical Specifications

Battery charger

Parameter	Butterfly ^{evo}
Input voltage	100 – 240 V AC
Output voltage	5 V DC

Battery parameters

Parameter	Butterfly ^{evo}	Butterfly-S ^{evo}
Internal battery voltage:	3.7 V	3.7 V
Battery capacity:	0.56 Ah	0.85 Ah
Full battery charging time	1.25 hrs	1.5 hrs
Average working time	>2 hrs @ max intensity	>2 hrs @ max intensity
Length:	50 mm	50 mm
Width:	24 mm	24 mm
Height:	9.5 mm	12 mm
Weight:	15 gr	20.5 gr

Light source

Parameter	Butterfly ^{evo}	Butterfly-S ^{evo}
Luminous intensity	145 LM	220 LM
Illuminance	35,000 LUX	55,000 LUX
Color temperature	5750 °K	5750 °K
Width:	50 mm	50 mm
Diameter	19 mm	19 mm
Weight (w/o battery)	9 gr	9 gr
LED operating resource	50,000 hrs	50,000 hrs
Spot size diameter at 350mm	70mm	70mm
External filter weight:	2 gr	2 gr

Charging pad

Parameter	Butterfly ^{evo}	Butterfly-S ^{evo}
Length:	60 mm	50 mm
Width:	80 mm	24 mm
Height:	13 mm	13 mm
USB Connector	USB Type-C	USB Type-C

Warranty

Admetec's warranty obligations for the **Butterfly^{evo}** are limited to the terms set forth below:

Admetec warrants the **Butterfly^{evo}** product against defects in materials and workmanship for a period of two (2) years for the headlight and one (1) year for all other supplied parts from the date of original purchase ("Warranty Period").







If a defect arises and a valid claim is received by Admetec within the Warranty Period, Admetec will (1) repair the product at no charge, using new or refurbished replacement parts, (2) exchange the product with a product that is new or which has been manufactured from new or serviceable used parts and is at least functionally equivalent to the original product.

If a defect arises and a valid claim is received by Admetec after the first ninety (90) days of the Warranty Period, a shipping and handling charge will apply to any repair or exchange of the product undertaken by Admetec.

When a product or part thereof is exchanged, any replacement item becomes your property, and the replaced item becomes Admetec's property.

Exclusions and Limitations

This warranty does not apply: (a) to damage caused by accident, abuse, misuse, misapplication, or non-Admetec products; (b) to damage caused by service performed by anyone other than Admetec; (c) to a product or a part that has been modified without the written permission of Admetec; or (d) if any Admetec warranty label has been removed or defaced.

	CE Mark indicating that the device complies with Regulation (EU) 2017/745 of the European Parliament and of the Council of 5 April 2017 on medical devices
	Admetec Solutions Ltd. Yokhanan HaSandlar St. 18 Haifa, 3296218, Israel
	Obelis Goup Bd Général Wahis, 53, Brussels, B-1030 Belgium
	Medical Device
	Caution! Consult accompanying documents
	Batch number
	Catalog number



If you have purchased Admetec-branded electrical or electronic products in the EU and are intending to discard these products at the end of their useful life, please do not dispose of them with your other household or municipal waste. Admetec has labeled its branded electronic products with the WEEE Symbol to alert our customers those products bearing this label should not be disposed of in a landfill or with municipal or household waste in the EU. Instead, contact the local e-waste recycling center.

Do you need customer service?

Please contact your local distributor.

admetec